

Contents

Note before use.....	2
Operation for Rubin Fingerprint Lock	
1. Notes for functional buttons.....	3
2. Save fingerprint.....	3
3. Delete fingerprint.....	4
4. Opening the door with fingerprint.....	6
5. Checking on user's ID number and the remaining space.....	6

Note before use

1. Memory capacity

15 persons, 30 fingerprints

2. Authority management

2 levels. The first 2 persons are administrators, 13 persons are users.

Only administrators can store and delete users' fingerprints and have password authority.

3. LED Display

User's ID: 01-15	Fingerprint space:15-00
Empty user: UU □ UU	Full users: FU □ FU

4. Low battery prompt

While opening the door, 6 beeps indicate low battery. Need to replace batteries. The lock still can use about 200 times.

Operation for Rubin Fingerprint Lock

1. Notes for functional buttons

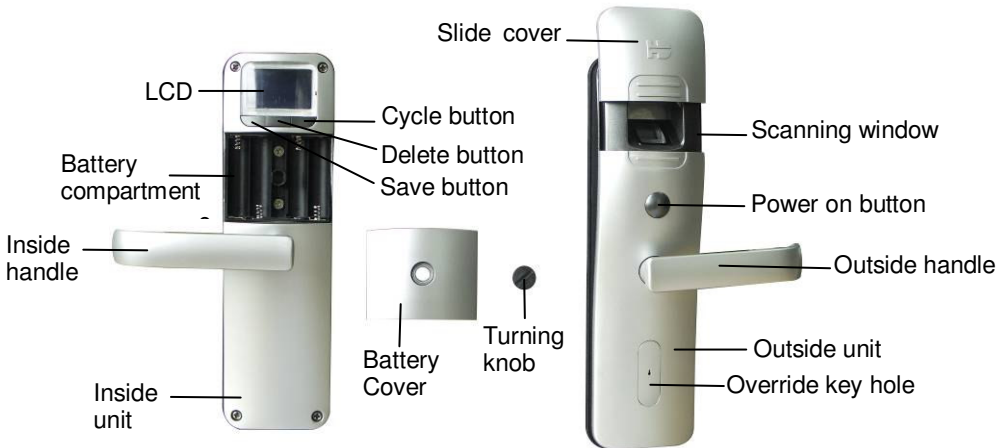

2. Save fingerprint

(1) Save administrator's fingerprint (01-02)



① Press Power on button.



② long press SAVE button and hear beep, LED displays 01:15



③ Put fingerprint on the scanning window, hearing beep, reposition the finger to scan the second fingerprint. Once success, 2 prompt beeps. 3 prompt beeps means failure.

After every administrator store fingerprint successfully, the lock will power off. The administrator must verify fingerprint, then go to the next step.

If you want to save users' fingerprint, the two administrators must be saved successfully first.

(2) Save users' fingerprints (03-15)



① Press power on button, the administrator verify the fingerprint



② LED displays the savable ID number. Long press SAVE button, Again long press SAVE button to store user's fingerprint (the same way as above for administrator).

If not power off, you can continuously store users' fingerprints as above operation until the memory is full (LED displays FU)

3. Delete fingerprint

(1) Delete user's fingerprints one by one (03-15)



① Press power on button, the administrator verify the fingerprint successfully, and then enter the status of deleting users.



② Press "CYCLE" button to select the user to be deleted.



③ Press DELETE button, until hear prompt beep. i.e. deletion is successful.

(2) Delete all saved fingerprints quickly(01-15)



① Press power on button, the administrator verify the fingerprint successfully.



□ Press STORE and DELETE button at the same time. And hold until hear the prompt beep, LED displays “UU : UU”, i.e. deletion is successful.

(3) Replace administrator’s fingerprint (01-02)

You can only replace the administrator’s fingerprint, but can’t delete it, when both administrator and user are exist in the lock.



① Press power on button, administrator verify the fingerprint successfully.



② Press DELETE button, hearing prompt beep to indicate storing replacer’s fingerprint. The alternative fingerprint is stored at the other administrator’s space.



③ The same way for replacing and storing fingerprint. When hearing 2 prompt beep, i.e. replacing is successful.

Three times failure for replacing fingerprint, the lock will power of. If continuously replace fingerprint, repeat the above operation.

(4) Forcedly delete administrator’s fingerprint (01-02)

This operation can delete the administrator’s fingerprint directly without verify the fingerprint, but there should no user’s fingerprint in the memory.



- ① Press DELETE button and hold.
- ② Press power on button, hearing prompt beep, remove DELETE button, LED displays "UU : UU", i.e. deletion is

4. Opening the door with fingerprint



- ① Press power on button.

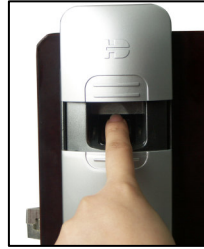

- ② Putting the saved fingerprint on the scanning window to verify, 2 prompt beep to indicate the door is open.

5. Checking on user's ID number and the remaining space



- ① Unlocking the door, Press "CYCLE" button to check on user's ID number and the remaining space.



- ② On the left of LED ,it displays the current ID number, on the right displays the remaining space.